

New Boats

Kadey-Krogen 64 Expedition Trawler

In 2007, Kadey-Krogen Yachts shared drawings for the 55' Expedition which debuted this past winter and received the People's Choice award at Trawler Fest in Stuart, Florida. The 55' Expedition continued to receive much attention and praise from both the media and the public and was deemed a perfect complement to the existing fleet of Krogens. Now, Kadey-Krogen Yachts is pleased to announce that the 55' with its raked bow, 360-degree pilothouse, and exceptional fit and finish is joined by a larger sistership, the Kadey-Krogen 64' Expedition.

Until now, the largest model offered by Kadey-Krogen has been their 58' but the company believes

there is room and interest in their buying audience for a bigger model so long as it can still be handled by a couple. The 64' Expedition is designed to be handled comfortably by two people, yet guests and/or crew can be accommodated with privacy for all as the 64' is available with multiple cabin and head lay-

out options.

The saloon of the 64' Expedition is located where every Kadey-Krogen saloon can be found: forward through the welded aluminum weather-tight doors off the fully covered aft deck. The portside galley remains amidships, directly adjacent to the saloon, so those who

are prepping and cooking are still a part of the conversation. The galley is well appointed with top-of-the-line stainless appliances including a four-burner Viking range, full-size Jenn-Air refrigerator, a super-quiet Miele dishwasher, a microwave/convection oven, and trash compactor. As a first for Kadey-Krogen,

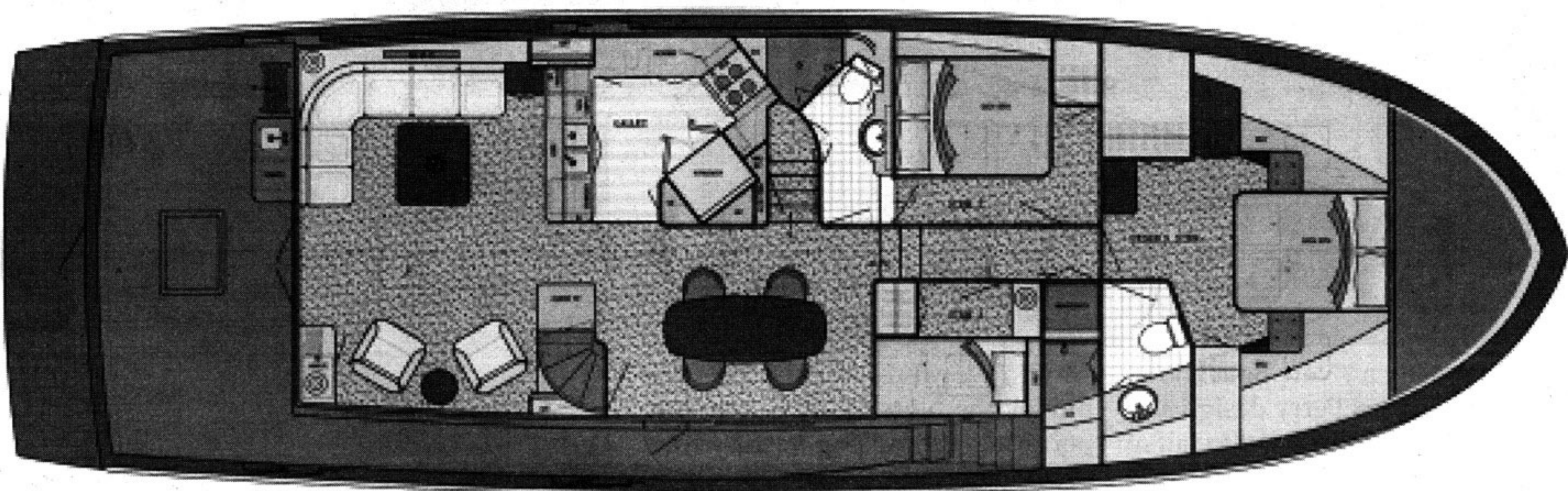

New Boats

there is a separate dining room to starboard, opposite the galley. The design crew at Kadey-Krogen can also accommodate the "must-haves" of an owner and will ensure the 64' Expedition meets the needs and expectations of its owners.

A wide walkway along the starboard side provides exterior access from the aft deck to the massive foredeck that is capable of handling a 17-foot tender and related equipment. For those that favor the looks of an expedition yacht but prefer to operate a vessel outside the pilot-house in fair weather, the 64' Expedition is available with a flybridge.

Kadey-Krogen vice president, Larry Polster, believes this new boat gives the company an opportunity to showcase how it can cater to cruisers who favor designs with maximum interior space without compromising handling, safety, or range. He also points out the architectural integrity of the design and says, "We don't stretch boats. The 64' is built using a dedicated mold and like the 55' it incorporates three keels. Engineering aboard the 55' was so well received that it was natural for Kadey-Krogen to extend those features and functions to the 64'."

Both Expedition models offer complete access to all machinery spaces from a single point of entry. Owners can move from the rudder post to the bow thruster through watertight doors in a machinery space boasting 6'6" of headroom. This feature makes the 64' unique in class and size, setting the 64' apart from its competitors.

The innovative three-keel design by Kadey-Krogen allows the Expedition model to have greater fuel efficiency than other keel forms. Each of the skegs to port and starboard is counter-faired, with the trailing end specially shaped to rotate water flowing into the propeller in the opposite direction of the propeller rotation resulting in greater operating efficiency.

The balanced, easy to propel hull form combined with continuous duty 231hp John Deere engines gives the 64' a range of 3,000nm at 9 knots. Supporting equipment in the engine room includes fuel polishing, oil exchange, and fire suppression systems; hydraulic stabilizers as well as bow and stern thrusters; chilled-water air conditioning; and a universal power converter—all are standard.

Like all Kadey-Krogens, the hull is built using vinylester and isophthalic resins, knytex mats, and US-made Cook® UV-protected gel coat to protect the vessel's gel coat.

Critical areas of the hull will be reinforced with a special impact-resistant fiberglass mat containing Twaron, the same fiber used to give body armor its "bullet-proof" capability. Twaron is an aramid fiber that is five times stronger than steel and up to 60% lighter than ballistic steel. This strong yet light fiber helps maintain a moderate displacement-to-length ratio that is a signature of Kadey-Krogen engineering and again results in better fuel economy.

For the potential buyer wondering where the new 64' Expedition can take them, Kadey-Krogen says

to simply choose a destination. From the machinery to the sophisticated joinerwork to quality customer service from day one, the 64' Expedition exemplifies the signature quality of Kadey-Krogen yachts in a design that inspires confidence and adventure for its owners. The best part is that while Kadey-Krogen is headquartered on the East Coast in Florida, the new West Coast Office in Seattle is open and as you might expect, is busier than ever because the new 55 Krogen has arrived. So if you want to get a feel for what the 64 will look like, now is your chance.

www.kadeykrogen.com

Specifications: Length Overall (LOA including swim platform & pulpit) 70'-4"; Length on Deck (LOD) 64'-0"; Length at Waterline (LWL) 62'-2"; Beam (Over Rub Rail) 20'-6"; Draft at Keel (half load) 5'6"; Displacement (half load) 167,000 lb. approx.; Ballast (Encapsulated Lead) 12,000 lbs. approx.; Fuel 3,000 U.S. gal.; Water 550 U.S. gal.; Black Water Capacity 175 U.S. gal.; Gray Water Capacity 175 U.S. gal.

Main Engines: John Deere 231hp (2); 9 knots: 3,000 Nautical Miles (estimated)